

2.1CH MULTIMEDIA SPEAKER SYSTEM

BT-230F



Thank you for your purchase of an authentic BOYTONE® product. Prior to first use, please read this manual carefully.

Operation explanation:

SPECIFICATIONS

Output Power: 30W+15Wx2(RMS)

Drive Units: 3" x2 full range magnetically shielded + 6.5" subwoofer

Frequency Response: Satellites: 120Hz-20KHz

Subwoofer:20Hz-170Hz

Separation: ≥40 dB

S/N: ≥60dB

Distortion: ≤0.5%(1K, 1W)

Power Supply: ~120V 60Hz

Dimensions: Subwoofer: W160xH277xD302(mm)

Satellite: W105xH170xD92(mm)

Features:

- Quality 2.1 speaker system with built-in amplifier
- Full audio spectrum performances, ideal for your favourite entertainment from Mp3, Mp4, CD/DVD movies and digital playbacks
- Specially designed woofer cabinet for bass and resolution
- Comes with remote control and 3.5mm stereo connection

Package contents:

subwoofer cabinet	1 pc
satellite speakers	2 pcs
remote control	1 pc
User manual	1 pc
Audio input cord	1 pc
FM ANT	1 pc

NO.1

Front panel

1. TUNING+/▶▶
2. TUNING-/◀◀
3. VOL-
4. ST-BY/▶
5. VOL+
6. SOURCE

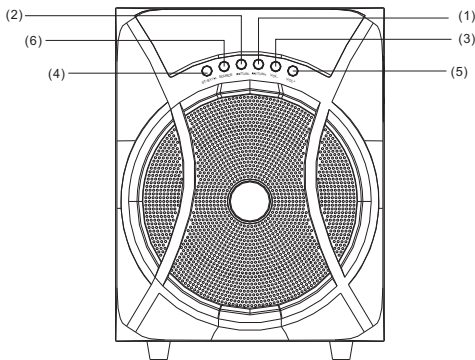

1. Power on the unit and it will be in standby mode with LED display showing " --- ". Pressing the "ST-BT/PLAY/PAUSE" button will display "AU 18" (this is the default volume level "18" for all of the unit's modes (volume range is 0~30dB). Long press "ST-BT/PLAY/PAUSE" for 3~5 seconds and the unit will revert to standby mode.
2. Press the "SOURCE" key to choose the input modes by the cycle order of "AUX-DVD-USB/SD-FM-BL". The LED display will indicate "Au18". "Du18". "Ud18". "87.5". "BI18".
3. In FM mode, short press the key "TUNING-/PREVIOUS", "TUNING+/NEXT" to manually tune station at increments of 0.1 MHz). Long press the key 3~5 seconds, and the unit will do automatically seek and memorize local FM stations.

NO.2

4. In USB/SD mode, press "TUNING-/PREVIOUS", "TUNING+/NEXT" to skip to the previous or next song.
5. In USB/SD mode, press "ST-BY/PLAY/PAUSE" to pause and play and long press to enter standby mode
6. Knob operation: turn right/left to increase/decrease the volume. The volume level is displayed on the LED display.
7. Play or pause the music by pressing "ST-BT/PLAY/PAUSE" quickly in USB/SD mode, and back to "ST-BY" mode by long pressing "ST-BY/PLAY/PAUSE" 3-5 seconds.
8. Press TONE key to adjust the TREBLE and BASS. Use the volume knob to adjust the TREBLE -6~+6 and the BASS 00~30.

Rear panel

1. ANTENNA
2. AUX/DVD INPUT Connect to audio sources such as PC, CD Player, MP3, etc.
3. Output: Connect the satellite speakers.
4. AC IN: AC Power cord

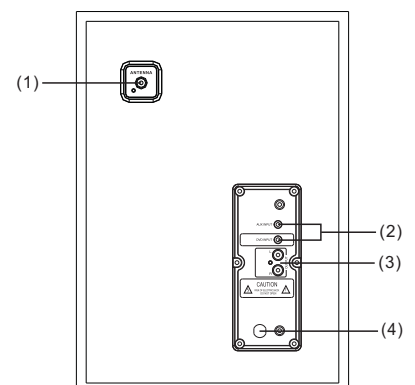

NO.3

Using The Remote Control

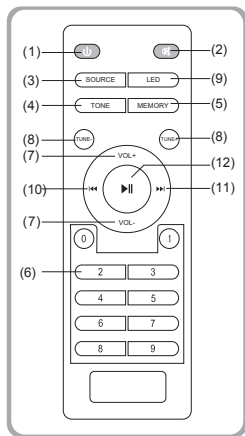

1. STAND-BY
2. MUTE
3. SOURCE
4. TONE
5. MEMORY
6. 0~9
7. VOL+/-
8. TUNE+/-
9. LED EFFECT
10. PREV/|<<
11. NEXT/>>|
12. PLAY/PAUSE

1. "ST-BY" - standby mode
2. "MUTE" - activates or deactivates mute.
3. "SOURCE" - select the AUX , DVD ,USB/SD,FM,BL input modes and the LED display will show "Au18" for AUX mode, "Du18" for DVD mode, "87.5" for FM mode and "BL" for Bluetooth mode.
4. "TONE" to adjust "TREBLE" and "BASS" Use "VOL+/-" to increase or decrease "TREBLE" or "BASS" levels.
5. When in FM Radio mode, press "MEMORY" and the station displayed will flash/blink. The machine is in station memorization mode. You can change the station by pressing "NEXT" or "PREV" and pressing "PLAY/PAUSE" will save that station for that station number. Automatic seek and save can be done by pressing "MEMORY" for 3-5 seconds
(Note: Previous saved channels will be deleted when you press "MEMORY" for 3-5 seconds.

NO.4

6. When in USB/SD mode. "NEXT/>>" for next song; "PREV/<<" for previous song; "PLAY/>/PAUSE/||" for play/pause; pressing "0-9" on the remote will play the corresponding song.
7. VOL+/- to increase or decrease volume.
8. "TUNING-/TUNING+ to adjust FM Radio frequency. Long press to fast scroll through frequencies without pause.
9. "LED" effect - press to change effect. Long press to deactivate.
10. "PREV" for previous song in USB/SD mode.
11. "NEXT" for next song in USB/SD mode.
12. "Play/Pause" to play and pause...but you definitely knew that.

CONNECTING YOUR BLUETOOTH DEVICE:

1. Press "SOURCE" until you are in "bL" mode. You will hear beeping.
2. Activate Bluetooth and search for "BT Speaker" on your transmitting device (phone, tablet, pc, etc.)

NO.5

System Connection Diagram

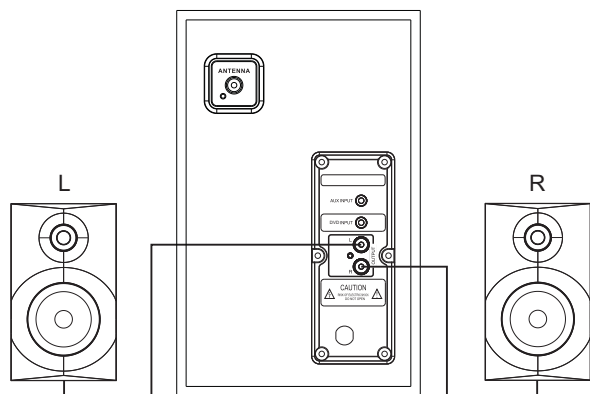

SPEAKER TERMINALS

Connect the left & right channel satellite to 2.1 speaker output terminals.



NOTE

* Do not leave objects generating magnetism near the speakers.

NO.6

Please pay attention to the following items:

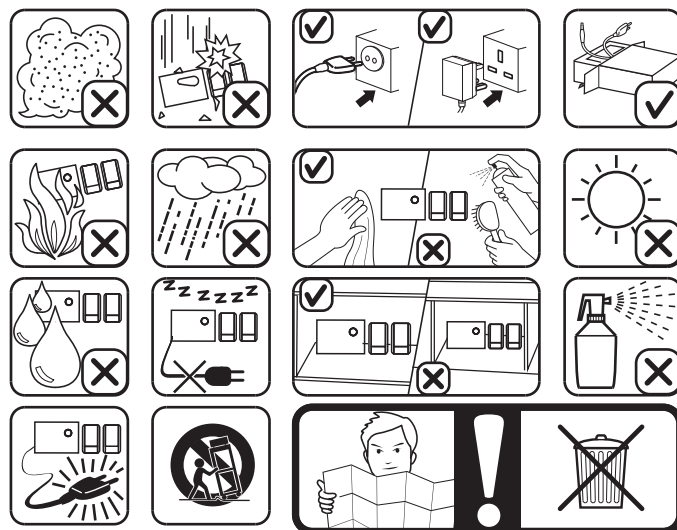

*If the remote control doesn't function, it is probably the battery of remote control being dead. Change 'em. Thank you.

NO.7